

ABVM-WiFi WRAS Actuated Ball Valve Manual



Technical Parameters:

Port Sizes: 1/4, 3/8, 1/2, 3/4 and 1 BSP thread (Optional NPT)

Maximum working pressure: 10 Bar

Media: Water (Optional Fluids and Gases)

Voltage: 5vDC

Current: 500mA Max

Valve Body: 304 Stainless Steel

Open/Close time: 10 Seconds Max

Cycles: 70,000

Actuator: Engineering Plastic

Torque: 3NM

Ambient Temp: +2°C to +50°C

Media Temp: -15°C to +90°C

Manual Override: Not available

Visual Position Indicator: Included

Control: Wi-Fi Smart Life APP

Stem Seal: PTFE

Ball Seals: PTFE/ EPDM (Optional PTFE/VITON)

Protection: IP67

Approvals: WRAS

Instructions:

Step 1:

Download “Smart Life” APP from the App Store or Google Play. Sign up and log in.

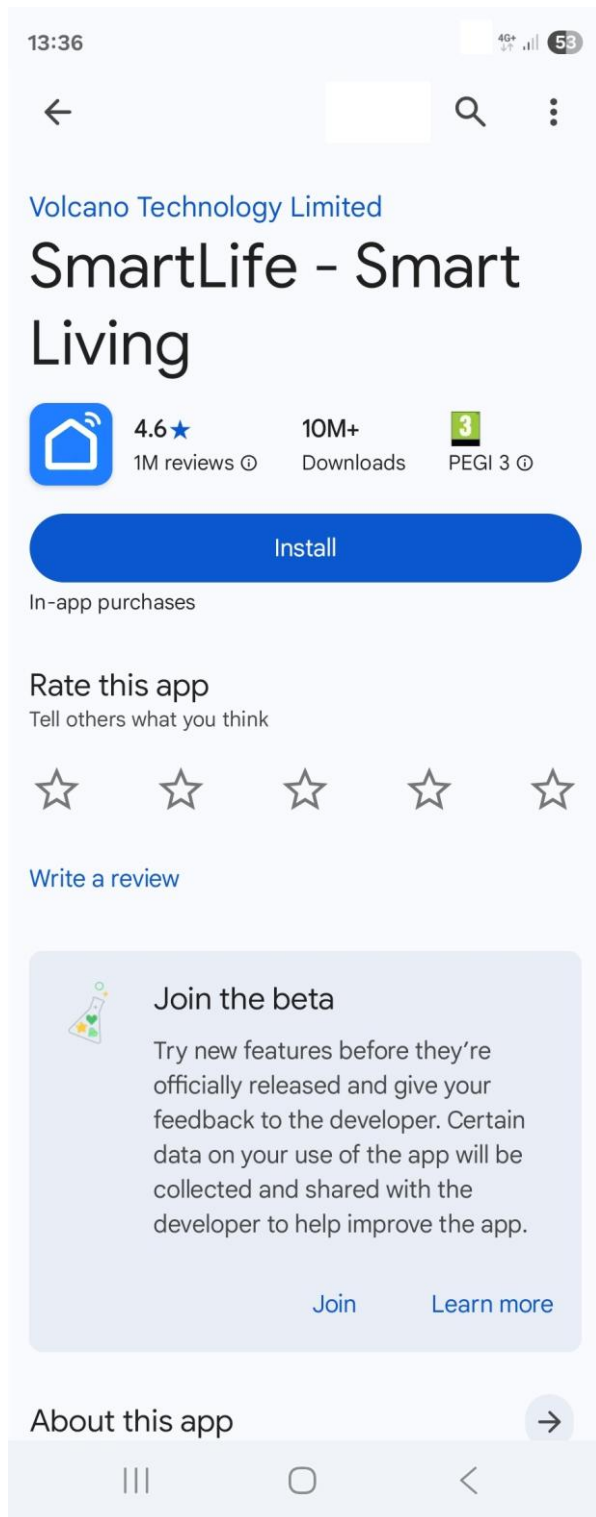

Step 2:

Click the + sign in the upper right corner to add a device.

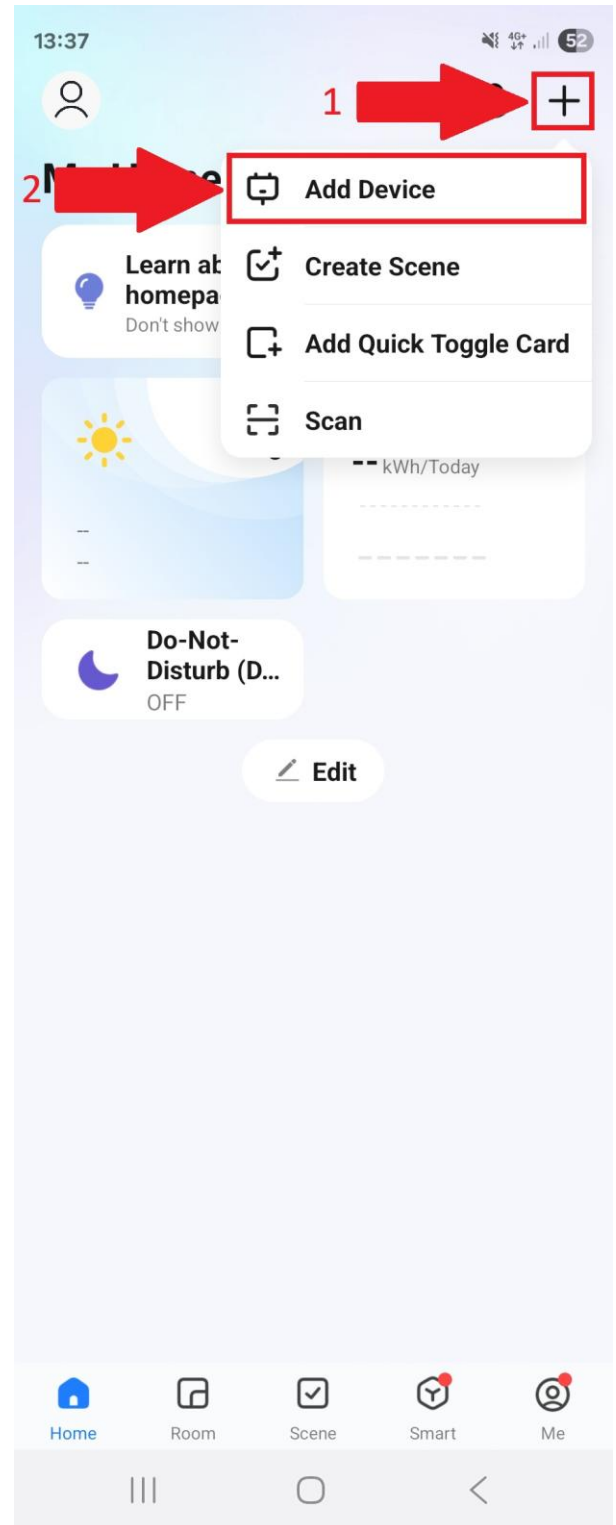

Step 3:

WIFI Electric valve connected to power supply.

Press and hold the button for 5 seconds until the yellow indicator light flashes, and the electric valve enters the distribution network state.

Step 4:

Accept Location and Bluetooth.

Step 5:

Click Radio Valve Controller.

Choose Your Home/ Work Wi-Fi and enter password,
device added successfully

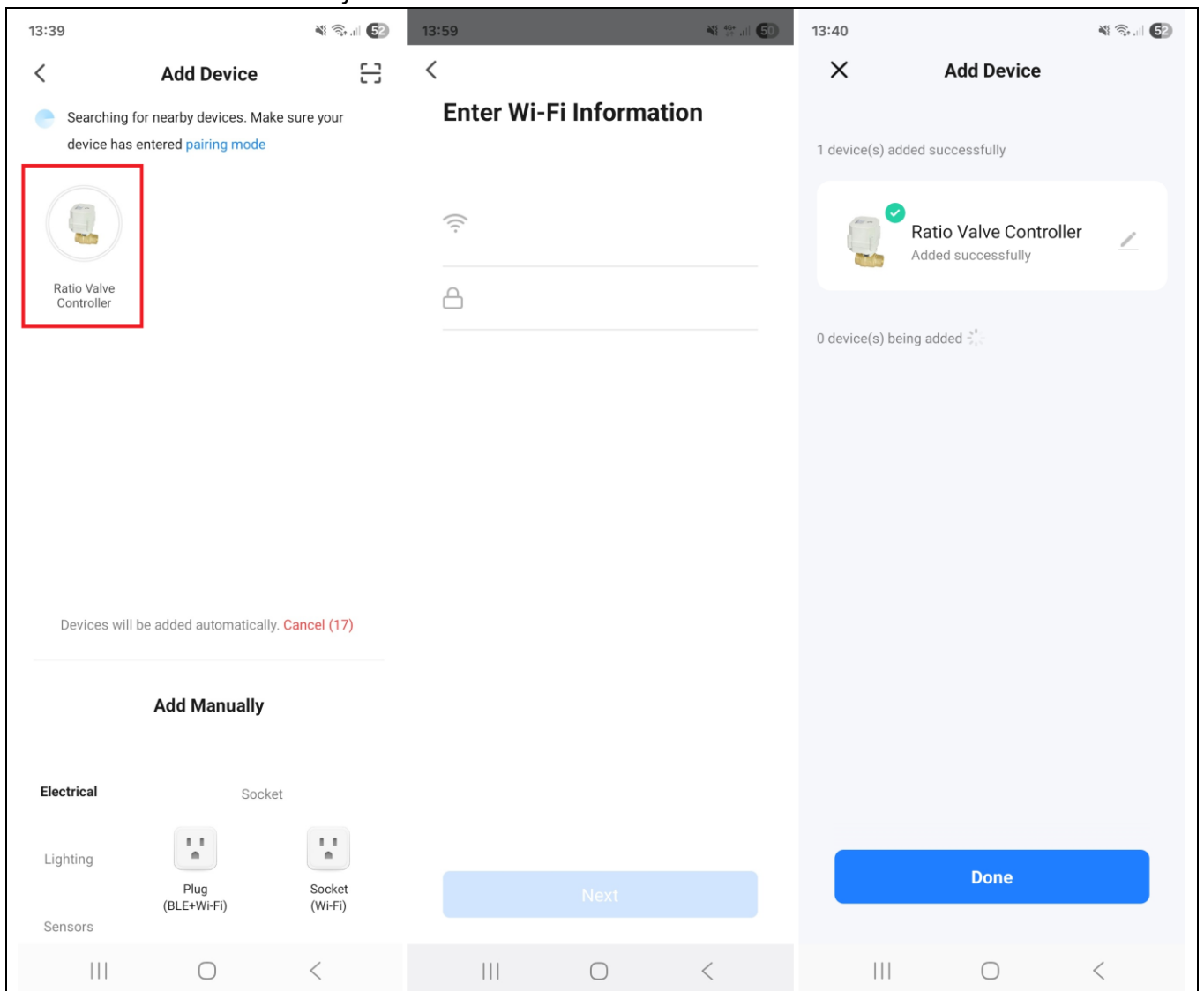
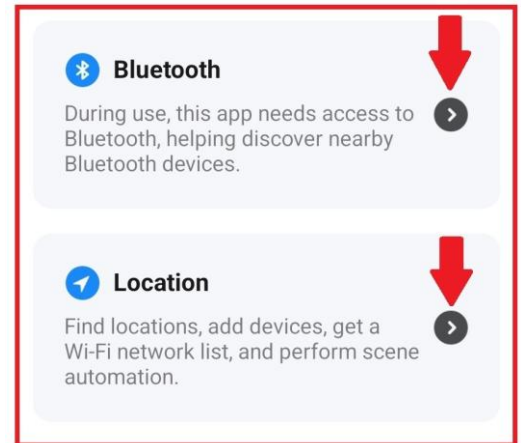

Step 6:

On the homepage, click “Ratio Valve Controller” to enter the parameter setting page. Click button “0%” to fully close the valve; Click button “100%” to fully open the valve.

The middle instrument panel controls the valve opening from 0 to 100%, with each step on the scale representing 10% of the valve open position.

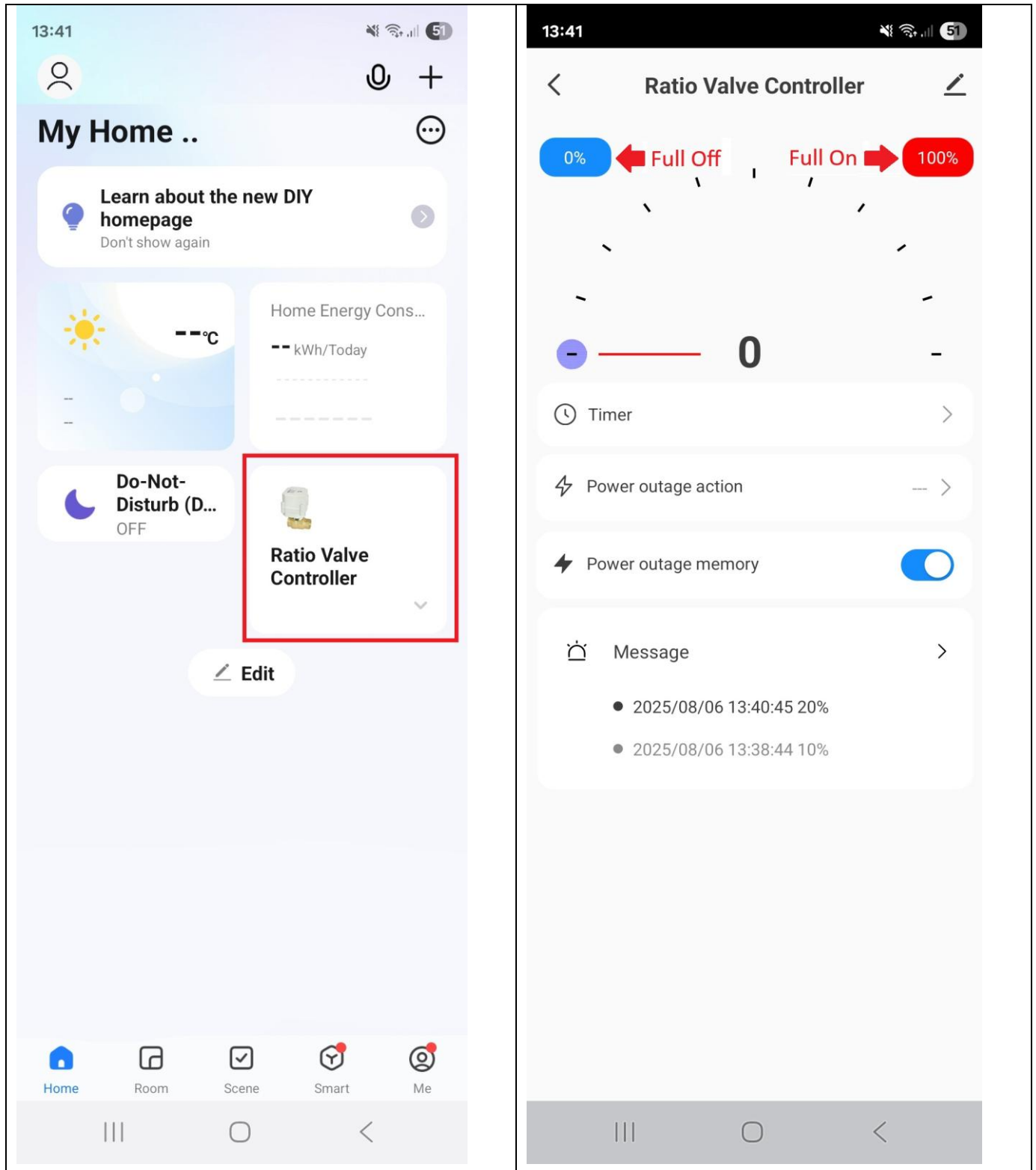

Timer:

You can set a time point in the day to open the valve to a fixed position.

For example, if you set the time: 8:30 and Repeat: Friday and Percent: 50%, the valve will open 50% at 8:30 every Friday.

The image displays two side-by-side screenshots of a mobile application interface for scheduling a valve action.

Left Screenshot: 'Add Schedule' screen

- Header: 13:42, signal strength, 51% battery.
- Navigation: Back arrow, 'Add Schedule' title, 'Save' button.
- Time selection: Three large numbers (12, 13, 14) and three small numbers (44, 45, 46) for HH:MM format.
- Repeat: 'Repeat' label, 'Once >' selection.
- Note: 'Note' label, '>' selection.
- Notification: 'Notification' label, toggle switch (off).
- Percent: 'Percent' label, '0 >' selection.
- Bottom bar: Three icons (list, circle, back).

Right Screenshot: 'Repeat' screen

- Header: 13:42, signal strength, 51% battery.
- Navigation: Back arrow, 'Repeat' title.
- Message: 'The action will be carried out only once if you do not select it.'
- Day selection: List of days (Sun., Mon., Tues., Wed., Thurs., Fri., Sat.) with radio buttons.
- Bottom bar: Three icons (list, circle, back).

Power Failure Default Function :

Upon power supply failure use “Power outage memory” function being turned on, set “Power outage action” where the valve closes after power failure. 0% means the valve is completely closed after power failure. 100% means the valve is completely open after power failure.

