

Media: air
 Pressure range: 1.5 to 8 Bar max
 Media temperature: +50°C max
 Ambient temperature: -10°C to +50°C max
 Mounting: any position
 Weight (including coil): 115, 180g

3/2 Single/Double Solenoid

1/8 1/4" 18mm Width

3/2 Normally Closed or Open

SERVO ASSISTED

1.5 – 10 Bar

TYPE BM320

3/2 Way Normally Closed BM320 Series



Ø Port BSP	Ø Orifice (mm ²)	Pressure Rating (Bar) ΔP		Max Work	Part Number
		Min	Max		
1/8	12	1.5	8	10	BM320-01S + voltage
1/4	16	1.5	8	10	BM320-02S + voltage



3/2 Way Normally Open BM320N Series



Ø Port BSP	Ø Orifice (mm ²)	Pressure Rating (Bar) ΔP		Max Work	Part Number
		Min	Max		
1/8	12	1.5	8	10	BM320N-01S + voltage
1/4	16	1.5	8	10	BM320N-02S + voltage



OPTIONS

IP65 Coil & Connector PG9 – DIN 43650 B & manual over ride (option flying lead wire coil F)
 NPT Thread
 ATEX 22001EX Coil: ATEX EExmII T4 II 2G & 2D IP65 T130°C ⚠
 BM320D double acting version (BM320-01/2D)

ELECTRICAL DATA

Voltage (-10% + 15%) Continuous duty 100%	Coil	Power Consumption		Insulation class	Enclosure	Electrical connections
		Inrush	Holding			
~ 24 - 110 - 230 (50 or 60 Hz)	22001	7.6 VA	6 VA	F 155°C	IP 65 with connector	3 spades DIN 43650B DIN 40050 VDE 0110
= 12 - 24 - 48 - 110 (DC)		4.5 Watts				

CONSTRUCTION

Body: Anodised Aluminium
 Tube and internal parts: Stainless steel
 Seals and gaskets: NBR
 Moulded coil: Resin

OVERALL DIMENSIONS

BM320-01S

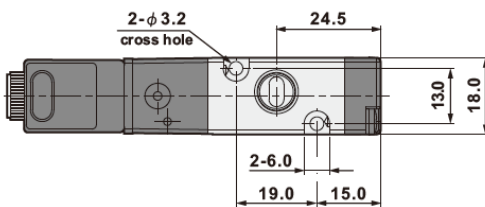

BM320-02S

