

Symbol

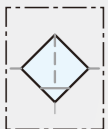

Filter

Features

- * Remove water and particle effectively.
- * 40 μ m and 5 μ m filter element are easily interchangeable and replaceable.



How to order

UF	-	02	N	C	H	B	A
Filter	Port size	Thread	Filtration	Drain	Mounting	Bowl	
02	1/4"	Blank G	PE	Blank	Blank	Blank	Blank
03	3/8"	N NPT	Blank 5 μ m	Semi-auto drain	W/O bracket	Standard bowl	
04	1/2"	R Rc	C 40 μ m	Manual drain	W/I bracket	Anti-acid & alkali bowl	
06	3/4"		Sintered brass	Auto drain		Aluminum bowl (1/4"~1/2")	
08	1"		S 5 μ m				
			T 40 μ m				

Specifications

Model	UF-02	UF-03	UF-04	UF-06	UF-08
Port size	1/4"	3/8"	1/2"	3/4"	1"
Fluid	Compressed air				
Body material	Aluminum die-cast				
Bowl material	Polycarbonate (Standard), Anti-acid & alkali bowl (Option), Aluminum bowl (Option)				
Filtration	PE: 5 μ m (Standard), 40 μ m (Option) Sintered brass (Option): 5 μ m ~ 40 μ m				
Operating pressure range	0.5 ~ 10 kgf/cm ²				
Proof pressure (Standard bowl)	15 kgf/cm ²				
Max. flow rate l/min (ANR)	2440	2450	3030	8250	8860
Ambient temperature	-10 $^{\circ}$ C ~ 60 $^{\circ}$ C				
Filter bowl capacity	105cc		210cc		
Standard drain	Semi-auto drain (Drains below 0.5kgf/cm ²)				
Net weight	530g (W/I Aluminum bowl 830g)			1250g	

Flow chart

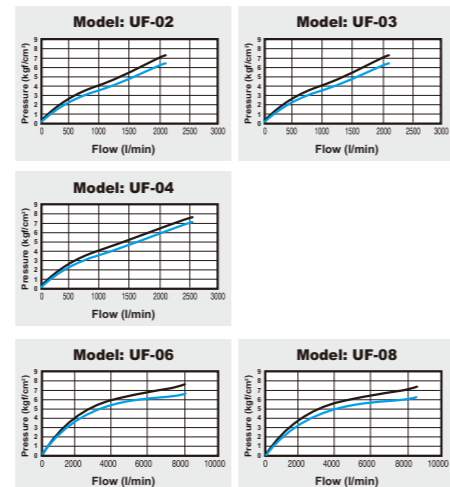

Note:

X axis: Flow (l/min)
Y axis: Pressure (kgf/cm²)
Blue line (P0) = Outlet pressure
Black line (P1) = Inlet pressure
P1-P0 = Pressure range

Dimensions

UF-02, 03, 04

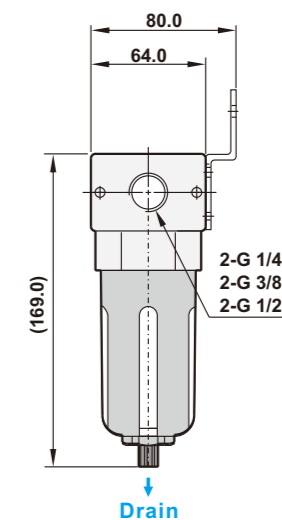
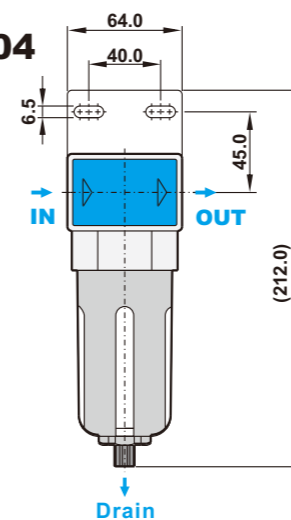

UF-02AL, 03AL, 04AL (Aluminum bowl)

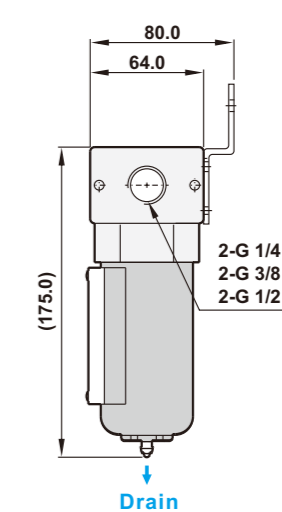
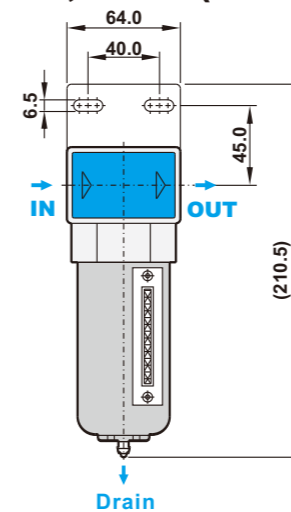

UF-06, 08

