

Media: air – water – gas – light oil - vacuum
 Pressure range: 0 to 30 Bar Max
 Media temperature: +145°C Max*
 Ambient temperature: -15°C to +50°C max
 Media viscosity: 40 centistokes max
 Mounting: any position
 Weight (including coil) 500 g
 Opening: 5-20 Close: 10 – 40 mSec Max

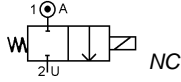

2/2 Stainless

1/8 – 1/4

NORMALLY CLOSED

2 WAY DIRECT ACTING

0 – 30 Bar

TYPE SC03-06



PRESSURE

Ø Port BSP xx	Ø Orifice (mm)	Pressure Rating (Bar)				Seals	Part Number	
		Min Torr	6 Watt Coil 2		ATEX Coil 2E			
			Max AC	Max DC	Max AC	Max DC		
1/8 (SC03)	1.0	10 ⁻²	30				NBR -5°C +80°C	SCxx12 + seal + voltage
	1.3		30	24	30		FKM -10°C +80°C	SCxx22 + seal + voltage
	1.6		30	20	30	24		SCxx32 + seal + voltage
	2.0	10 ⁻¹	16	11	17	14	EPDM -10°C +80°C	SCxx42 + seal + voltage
	2.5		10	7	10	10	PTFE + FFKM -20°C +80°C	SCxx52 + seal + voltage
	3.0		6	4	7	5		SCxx62 + seal + voltage
5.0	10	1	0.2	1	0.1	SCxx82 + seal + voltage		
		Min Torr	6.8 Watt Coil 3				Seals	Part Number
			Max AC	Max DC	Max AC	Max DC		
1/8 (SC03)	1.0	10 ⁻²	30				NBR -5°C +80°C	SCxx13 + seal + voltage
	1.3		30					SCxx23 + seal + voltage
	1.6		30					SCxx33 + seal + voltage
	2.0	10 ⁻¹	22	20			FKM, EPDM	SCxx43 + seal + voltage
	2.5		12	10			PTFE, FFKM	SCxx53 + seal + voltage
	3.0		8	8			-10°C +145°C	SCxx63 + seal + voltage
5.0	10	2	0.5				SCxx83 + seal + voltage	

OPTIONS

IP65 22mm width Coil & Connector PG9 – DIN 43650 A
 NPT Thread
 EPDM (J) or FKM (V) seals
 PTFE (T) Max Orifice 2.5mm
 FFKM (Kalrez Z) Max Orifice 3mm
 ATEX Coil: 8/30 EExmIIT4 II ATEX 2G IP65 T 130°C

Included

ELECTRICAL DATA

Voltage (-10% + 15%) Continuous duty 100%	Coil	Power Consumption		Insulation class	Enclosure	Electrical connections
		Inrush	Holding			
~ 12-24-48-110-230 (50/60 Hz)	22001/5 Coil 2 22mm	14 VA	8.5 VA	F 155°C	IP 65 with connector	3 spades DIN 43650 DIN 40050 VDE 0110
= 12-24-48-110-220 (DC)		6 Watts				
~ 24-48-110-230 (50 or 60 Hz)	22002/6 Coil 3 30mm	17VA	10.5VA			
= 12-24-48 (DC)		6.8 Watts				

CONSTRUCTION

Body: AISI303 Stainless steel, Tube and internal parts: AISI304 stainless steel
 Head & plunger: AISI 430Fr Stainless steel
 Seals and gaskets: NBR Optional EPDM, FKM, NBR, FFKM (Kalrez) or PTFE
 Moulded coil: Resin

REPAIR KIT

Coil	Coil size (22001/5 or 22002/6) + voltage
Complete Armature assembly	SP + Valve Part Number -ARMATURE

OVERALL DIMENSIONS

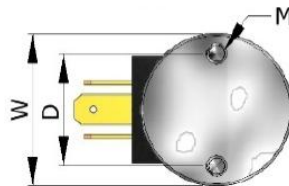
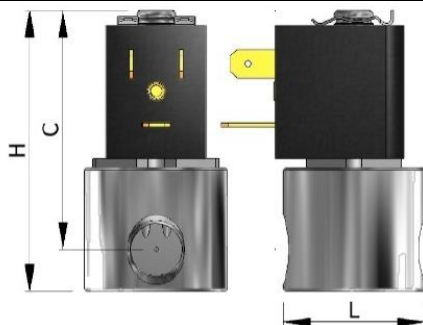

OPTION ACCESSORY : Bracket

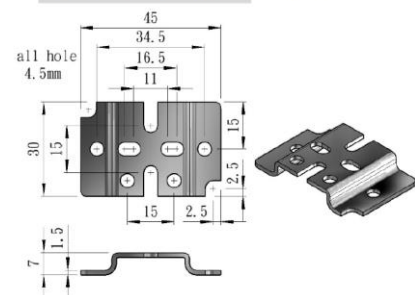

Port	L	W		H	C	D	M	Kg		
		Coil 2	Coil 2E ATEX					Coil 22001	Coil 22002	Coil ATEX
SC03 1/8	25	25	30	58	51	18	M	0.18	0.23	0.50
SC06 1/4	30			63	53	23	4	0.23	0.28	0.55