

Media: air – water – gas – light oil
 Pressure range: 0.5 to 15 Bar max
 Media temperature: -40°C to +180°C max
 Ambient temperature: -20°C to +60°C
 Media viscosity: 50 centistokes max
 Mounting: coil upright
 Opening / Closing time: 50 mSec Max

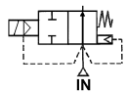

NO

2/2 Brass

3/8 – 3"

NORMALLY OPEN

2 WAY SERVO ASSISTED

0.5 – 15 Bar

TYPE NOPU225®



PRESSURE

Ø Port BSP	Ø Orifice (mm)	Flow Kv Ltr/ min	Coil	Pressure Rating (Bar) ΔP		Max Working	Seals	Max Media Temp. °C	Part Number
				Min	Max				
3/8	13	40.0	22003	0.5	10	15	NBR -15°C to +80°C	NBR FKM EPDM	NOPU22503 + voltage NOPU22503V + voltage NOPU22503E + voltage
1/2	13	40.0	22003	0.5	10	15			NBR FKM EPDM
3/4	25	165.0	22003	0.5	10	15	EPDM -5°C to +130°C	NBR FKM EPDM	NBR FKM EPDM
1	25	165.0	22003	0.5	10	15			NBR FKM EPDM
1 1/4	38	367	22003	0.5	10	15	Viton -10°C to +180°C	NBR FKM EPDM	NBR FKM EPDM
1 1/2	38	500	22003	0.5	10	15			NBR FKM EPDM
2	50	600	22003	0.5	10	15	HNBR -40°C to +150°C	NBR FKM EPDM	NBR FKM EPDM
2 1/2	65	1050	16W	0.3	10	15			NBR FKM EPDM
3	75	1380	16W	0.3	10	15	HNBR not available	NBR FKM EPDM	NBR FKM EPDM
									NBR FKM EPDM
									NBR FKM EPDM
									NBR FKM EPDM
									NBR FKM EPDM
									NBR FKM EPDM
									NBR FKM EPDM
									NBR FKM EPDM
									NBR FKM EPDM
									NBR FKM EPDM
									NBR FKM EPDM
									NBR FKM EPDM
									NBR FKM EPDM
									NBR FKM EPDM
									NBR FKM EPDM
									NBR FKM EPDM
									NBR FKM EPDM

OPTIONS

IP65 Coil & Connector PG9 – DIN 43650 A
 ATEX 22003EX Coil: ATEX EExmII T4 II 2G & 2D IP65 T130°C (21/2 + 3" not available in this series)
 NPT Thread (Not available 21/2 + 3")
 HNBR seals, degreased, flange

Included

ELECTRICAL DATA

Voltage (-10% + 10%) Continuous duty 100%		Coil	Power Consumption		Insulation class	Enclosure	Electrical connections
~	=		Inrush	Holding			
~ 12-24 – 48 – 110 – 240 – 380 (50/ 60 Hz)	= 12 – 24 – 48 – 110 – 220 (DC)	22003	23VA	17VA	H 180°C	IP 65 with connector	3 spades DIN 43650A DIN 40050 VDE 0110
~ 24 – 48 – 110 – 230 – 380 (50/ 60 Hz)	= 12 – 24 – 48 (DC)		16W	25VA			
			15 Watts				
			16 Watts				

CONSTRUCTION

Body: Forged Brass SS41, Tube and internal parts: Stainless steel, Seals and gaskets: NBR (Optional EPDM & FKM & HNBR)
 Moulded coil: 16 W Resin / 22003 DuroPlast ThermoSet Resin

REPAIR KIT

Seal kit	ZGPU225 + size code (03-20) + seal material
Coil	Coil size (22003 or 16W) + voltage
Armature assembly (Normally Open)	225320NO + seal material (not 21/2 + 3")

OVERALL DIMENSIONS

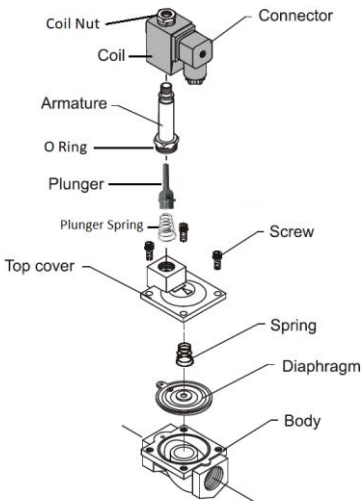

Port	PU225 03 04	PU225 06 08	PU225 12 14	PU225 20	PU225 24	PU225 28
A	66.5	96	131	160	243	250
B	106.5	126.5	145.5	160.5	178	188
C	48	70	96	112	184	184
Kg	0.725	1.565	2.56	3.9	9.4	11.4

