

Media: air – water – gas – Vacuum 10^{-3}
 Pressure range: 0 to 12 Bar max
 Media temperature: -10°C +70°C max
 Ambient temperature: -40°C to +50°C
 Media viscosity: 50 centistokes max
 Mounting: coil upright

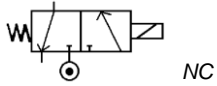

2/2 + 3/2 Brass

EEx ia IIC T/ IEC Ex ia IIC T

NORMALLY CLOSED

DIRECT ACTING

0 – 8 Bar

TYPE PU221/ PU321



PRESSURE

Ø Port BSP	Ø Orifice (mm)	Flow Kv Ltr/ min	Pressure Rating (Bar)ΔP		Max Working (Bar)	Function	Part Number	List Price
			Min	Max				
1/8	0.8	0.3	0	8	12	2/2	PU22101A9T4	£181.79
1/4	0.8	0.3	0	8	12	2/2	PU22102A9T4	
1/8	0.8	0.3	0	8	12	2/2	PU22101A9T6	
1/4	0.8	0.3	0	8	12	2/2	PU22102A9T6	
1/8	0.8	0.3	0	8	12	3/2	PU32101A9T4	
1/4	0.8	0.3	0	8	12	3/2	PU32102A9T4	
1/8	0.8	0.3	0	8	12	3/2	PU32101A9T6	
1/4	0.8	0.3	0	8	12	3/2	PU32102A9T6	

OPTIONS

24vDC ATEX II 2 G Ex ia IIB/C T6 Ga, IEC Ex ia IIB/C T6 Ga, (Ambient -40°C to +50°C) (Ref: 125930.1-00/5146)
 ATEX Connector PG9 – DIN 43650 A (611-201-1317) and ATEX 3 way Armature (1237 07.6-00)
 EC Certificate PTB 02 ATEX 2154 and IECEx PTB 08.0023
 24vDC ATEX II 2 G Ex ia IIB/C T4 Ga, IEC Ex ia IIB/C T4 Ga, (Ambient -40°C to 85°C) (Ref: 125950.1-00/5146)

Included Included Included +£0.00

ELECTRICAL DATA

Voltage (-10% + 10%) Continuous duty 100%	Coil	Power Consumption	Insulation class	Enclosure	Electrical connections
= 24 (DC)	125930.1-00/5146	1.6 Watts	F 155°C	IP 65 with connector	3 spades DIN 43650A DIN 40050 VDE 0110
Temperature +20C +50°C +85°C	Minimum Switching Power Supply 37mAmp 37mAmp 37mAmp	Nominal Resistance of solenoid 275 ohm 310 ohm 350 ohm			
Supply for connection to intrinsically safe circuits of category ia	Maximum Values Ui <= 28V L=Li <= 115 mA Pi <= 1.6 W	The effective inductance and capacitance of the solenoid are negligibly low. Li ~ 0 Ci ~ 0			

The solenoid must be connected by inserting related intrinsically safe work equipment (Isolating barrier) in accordance with the manufacturer's instructions.

CONSTRUCTION

Body: Brass, Tube and internal parts: Stainless steel, Seals and gaskets: NBR
 Exhaust M5, Moulded coil: ThermoSet Resin

REPAIR KIT

Armature + Tube Assembly	123707.6-00
Coil (ExiaIIC T6)	125930.1-00/5146
Coil (ExiaIIC T4)	125950.1-00/5146
ATEX Connector	611-201-1291

OVERALL DIMENSIONS

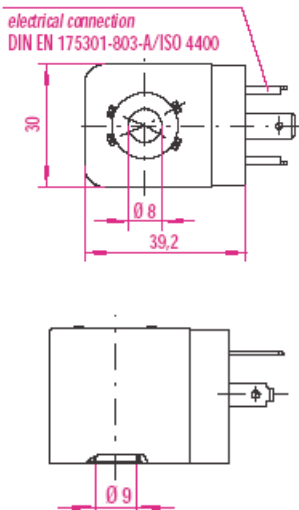

Port	1/8	1/4
A	22	25.4
B	22	35
C	72	75
D	15	18
E	11	17.5
F	22	25.4
G	7.5	12.7
H	M4 P0.7*L6.5	M5 P0.8*L7.0

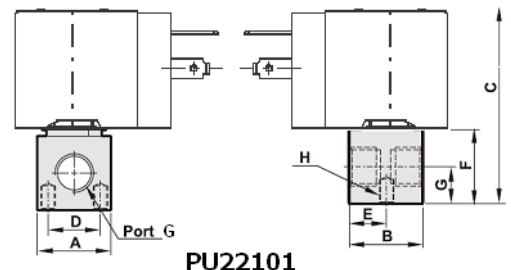

PU22101

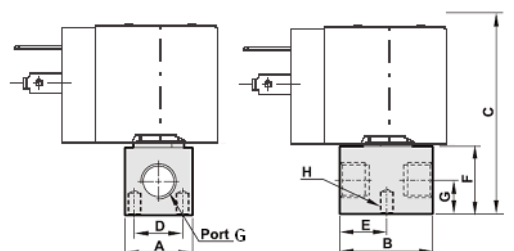

PU22102